

MINUTES OF THE REGULAR MEETING OF THE
LOUISIANA PROFESSIONAL ENGINEERING
AND LAND SURVEYING BOARD
9643 BROOKLINE AVENUE, SUITE 121
BATON ROUGE, LOUISIANA 70809-1433
September 23, 2024

At 9:03 a.m. on September 23, 2024, Connie P. Betts, P.E. called the meeting to order at the Board's office in Baton Rouge, Louisiana, with the following members present:

Reginald L. Jeter, P.E.	Chairman
Connie P. Betts, P.E.	Vice Chairman
Linda H. Bergeron, P.E.	Treasurer
Byron D. Racca, P.E.	Secretary

James H. Chustz, Jr., P.L.S.
Janice P. Williams, P.E.
Vijaya Gopu, Ph.D., P.E.
Gordon E. Nelson, P.E.
Susan H. Richard, P.E.

Also present: Donna D. Sentell, Executive Director
Cheron Seaman, Deputy Executive Director
Joe Harman, P.E., Technical Advisor
David Patterson, P.L.S., Technical Advisor
D. Scott Landry, Board Attorney
Bill Tripoli, IT Director
Janet Lindsey, Application Manager
Rhett Rayburn, Staff
Carlos Morgan, Staff

Gary Thompson, P.L.S. North Carolina (*via Zoom video teleconference*)
Jeffrey Messinger, P.L.S. (*via Zoom video teleconference*)

Absent: Wilfred J. Fontenot, P.L.S.

Ms. Betts presented the Chairman gavel to Mr. Jeter. Mr. Jeter presented Ms. Betts with a plaque in recognition of her time serving as Chairman of the Board.

The invocation was led by Mr. Nelson and the pledge was led by Ms. Bergeron.

Public comment time was recognized by Chairman Jeter. Mr. Thompson and Mr. Messinger were recognized.

The Board unanimously approved the motion made by Mr. Racca, seconded by Ms. Betts, to accept the September 23, 2024 proposed Call and Agenda for the meeting.

The Board unanimously approved the motion made by Mr. Nelson, seconded by Ms. Bergeron, to approve the minutes from the July 29, 2024 Board meeting.

Committee Reports

Land Surveying Committee

Mr. Thompson discussed the NCEES effort to develop a mapping and science surveying exam. After discussion, the Board unanimously approved the motion made by Ms. Betts, seconded by Mr. Racca, to provide a letter of support to NCEES concerning the development of a mapping and science surveying exam.

Mr. Messinger discussed the concerns of the Louisiana Society of Professional Surveyors regarding Acts 253 and 568 of the 2024 Regular Session of the Louisiana Legislature (Welcome Home Act).
Mr. Thompson exited the meeting at 9:12 a.m. and Mr. Messinger exited the meeting at 9:19 a.m.

1
2 **Compliance and Enforcement**
3

4 **Case # 2024-10** – Ms. Georgetown reported on an unlicensed firm which (a)
5 practiced and/or offered to practice engineering and using the words “engineer”,
6 “engineering” or any modification or derivative thereof in a person’s name or form of
7 business or activity without proper licensure and (b) committed fraud, deceit,
8 material misstatement or perjury, or gave false or forged evidence, in applying for a
9 license with the Board. The respondent has signed and returned the proposed
10 consent order offered by the Complaint Review Committee. The proposed consent
11 order contained the following sanctions:

- 12 1. Fine of \$3,750
13 2. Costs of \$1,014.57
14 3. Publication on the Board’s website and in the Journal with name
15 4. Report to NCEES with name

16 After discussion, the Board unanimously approved the motion made by the Complaint
17 Review Committee, consisting of Dr. Gopu, Mr. Chustz and Mrs. Williams, to approve
18 the signed consent order. The name of the respondent is **Integrated Food**
19 **Engineering LLC.**
20

21 **Case # 2024-27** – Ms. Georgetown reported on a professional engineer who (a)
22 practiced and/or offered to practice engineering prior to licensure, (b) committed
23 fraud, deceit, material misstatement or perjury, or gave false or forged evidence, in
24 applying for a license with the Board and (c) aided or assisted another person in
25 violating the laws and/or rules of the Board. The respondent has signed and returned
26 the proposed consent order offered by the Complaint Review Committee. The
27 proposed consent order contained the following sanctions:

- 28 1. Fine of \$3,000
29 2. Costs of \$1,014.57
30 3. Louisiana Laws & Rules Quiz
31 4. Louisiana Professionalism & Ethics Quiz
32 5. Immediate suspension of license if fail to comply with any portion of consent
33 order, with suspension continuing until compliance
34 6. Publication on the Board’s website and in the Journal with name
35 7. Report to NCEES with name

36 After discussion, the Board unanimously approved the motion made by the Complaint
37 Review Committee, consisting of Dr. Gopu, Mr. Chustz and Mrs. Williams, to approve
38 the signed consent order. The name of the respondent is **Andrew J. Milesen, P.E.**
39

40 **Committee Reports (continued)**
41

42 **Laws and Rules Committee**
43

44 Mr. Landry presented the proposed revisions to Rules 903, 909, 2503 and 2701, all
45 related to licensure by endorsement. After discussion, the Board unanimously
46 approved the motion made by Mr. Chustz, seconded by Ms. Bergeron, to amend Rules
47 903, 909, 2503 and 2701 as follows:
48

49 **§903. Professional Engineer Licensure**

50 A. – E.2. ...

51 F. The requirements for licensure as a professional engineer under the
52 alternative provided in R.S. 37:51 et seq. are as follows:

- 53 1. the applicant for licensure as a professional engineer shall be an
54 individual who holds a current and valid license to engage in the practice of
55 engineering issued to him/her by proper authority of a state, territory, or
56 possession of the United States, or the District of Columbia, who has held such
57 license for at least one year, who has passed any examinations or met any
58 education, training, or experience standards as required by such other
59 jurisdiction, who is held in good standing by such other jurisdiction, who does
60 not have a disqualifying criminal record as determined by the board under the
61 laws of this state, who does not have a disciplinary action or investigation
62 pending in another state, territory, or possession of the United States, or the
63 District of Columbia, who lives in this state and has provided proof of residency,
64 who has submitted an application for licensure in accordance with the
65 requirements of R.S. 37:694, and who was duly licensed as a professional
66 engineer by the board

1 G. The provisions of Subsections B, C and D shall not apply to any applicant
2 who received a dishonorable discharge or to a military spouse whose spouse
3 received a dishonorable discharge.

4 H. In Subsections B, C and D, the term *military* shall mean the armed forces
5 or reserves of the United States, including the Army, Navy, Marine Corps, Coast
6 Guard, Air Force, and the reserve components thereof, the National Guard of
7 any state, the military reserves of any state, or the naval militia of any state.

8 I. In Subsections B, C and D, the term *dependent* shall mean a resident
9 spouse or resident unmarried child under 21 years of age, a child who is a
10 student under 24 years of age and who is financially dependent upon the
11 parent, or a child of any age who is disabled and dependent upon the parent.

12 J. In Subsection E, the term *dependent* shall mean any of the following who
13 relocates to Louisiana with a healthcare professional:

14 J.1. – J.4. ...

15 K. In Subsection E, the term *healthcare professional* shall mean a person
16 who has relocated to and established his/her legal residence in Louisiana, who
17 holds a valid license to provide healthcare services in Louisiana and who is
18 providing healthcare or professional services in Louisiana as a physician,
19 physician assistant, dentist, registered or licensed practical nurse or certified
20 nurse assistant, advanced practice registered nurse, certified emergency
21 medical technician, paramedic, certified registered nurse anesthetist, nurse
22 practitioner, respiratory therapist, clinical nurse specialist, pharmacist,
23 physical therapist, occupational therapist, licensed radiologic technologist,
24 chiropractor, or licensed clinical laboratory scientist.

25 L. In Subsection F, proof of residency in this state shall be established by
26 providing to the board one or more of the following:

- 27 1. a current state of Louisiana-issued identification card;
28 2. a current state of Louisiana-issued voter registration card;
29 3. documentation of current employment of the applicant in this state or a
30 notarized letter of a promise of employment of the applicant or his/her spouse
31 in this state; however, if this form of proof of residency is provided, the
32 applicant shall also provide to the board one or more of the other forms of
33 proof of residency six months after licensure has been granted by the board; or
34 4. a current homestead exemption for this state.

35 M. The authority for the executive director to issue a license can only be
36 granted by the board.

37
38 **§909. Professional Land Surveyor Licensure**

39 A. – E.2. ...

40 F. The requirements for licensure as a professional land surveyor under the
41 alternative provided in R.S. 37:51 et seq. are as follows:

- 42 1. the applicant for licensure as a professional land surveyor shall be an
43 individual who holds a current and valid license to engage in the practice of
44 land surveying issued to him/her by proper authority of a state, territory, or
45 possession of the United States, or the District of Columbia, who has held such
46 license for at least one year, who has passed any examinations or met any
47 education, training, or experience standards as required by such other
48 jurisdiction, who is held in good standing by such other jurisdiction, who does
49 not have a disqualifying criminal record as determined by the board under the
50 laws of this state, who does not have a disciplinary action or investigation
51 pending in another state, territory, or possession of the United States, or the
52 District of Columbia, who lives in this state and has provided proof of residency,
53 who has passed the examination required by the board in the Louisiana laws of
54 land surveying, who has submitted an application for licensure in accordance
55 with the requirements of R.S. 37:694, and who was duly licensed as a
56 professional land surveyor by the board.

57 G. The provisions of Subsections B, C and D shall not apply to any applicant
58 who received a dishonorable discharge or to a military spouse whose spouse
59 received a dishonorable discharge.

60 H. In Subsections B, C and D, the term *military* shall mean the armed forces
61 or reserves of the United States, including the Army, Navy, Marine Corps, Coast

Guard, Air Force, and the reserve components thereof, the National Guard of any state, the military reserves of any state, or the naval militia of any state.

I. In Subsections B, C and D, the term *dependent* shall mean a resident spouse or resident unmarried child under 21 years of age, a child who is a student under 24 years of age and who is financially dependent upon the parent, or a child of any age who is disabled and dependent upon the parent.

J. In Subsection E, the term *dependent* shall mean any of the following who relocates to Louisiana with a healthcare professional:

J.1 – J.4 ...

K. In Subsection E, the term *healthcare professional* shall mean a person who has relocated to and established his/her legal residence in Louisiana, who holds a valid license to provide healthcare services in Louisiana and who is providing healthcare or professional services in Louisiana as a physician, physician assistant, dentist, registered or licensed practical nurse or certified nurse assistant, advanced practice registered nurse, certified emergency medical technician, paramedic, certified registered nurse anesthetist, nurse practitioner, respiratory therapist, clinical nurse specialist, pharmacist, physical therapist, occupational therapist, licensed radiologic technologist, chiropractor, or licensed clinical laboratory scientist.

L. In Subsection F, proof of residency in this state shall be established by providing to the board one or more of the following:

1. a current state of Louisiana-issued identification card;
2. a current state of Louisiana-issued voter registration card;
3. documentation of current employment of the applicant in this state or a notarized letter of a promise of employment of the applicant or his/her spouse in this state; however, if this form of proof of residency is provided, the applicant shall also provide to the board one or more of the other forms of proof of residency six months after licensure has been granted by the board; or
4. a current homestead exemption for this state.

M. The authority for the executive director to issue a license can only be granted by the board.

§2503. Licensees

A. – H. ...

I. A licensee who was licensed under R.S. 37:51 et seq. and either §903.F or §909.F shall not be identified as a professional engineer, professional land surveyor, P.E., P.L.S., or any modification or derivative thereof, as applicable, unless the phrase "Licensed by Endorsement, R.S. 37:51 et seq." immediately follows such identification.

§2701. Seal and Signature

A. – A.2.a.iii. ...

iv. "Professional Engineer" or "Professional Engineer in _____ Engineering," or "Professional Land Surveyor";

v. "Licensed by Endorsement, R.S. 37:51 et seq." (if licensee was licensed under R.S. 37:51 et seq. and either §903.F or §909.F).

Seals issued prior to promulgation of these rules may use the word "registered" in lieu of "licensed". If a seal is replaced, the new seal shall use the word "licensed" in lieu of "registered".

A.2.b – A.2.e. ...

f. A seal must always be accompanied by the licensee's signature and date. The signature and date must be placed adjacent to or across the seal.

1

2

3

4

5

6
7
8
9
10
11
12
13
14
15
16
17

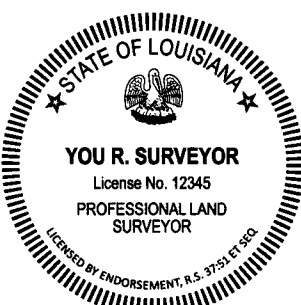
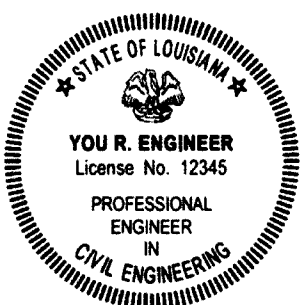
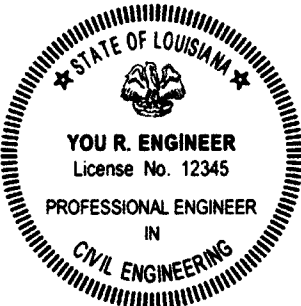
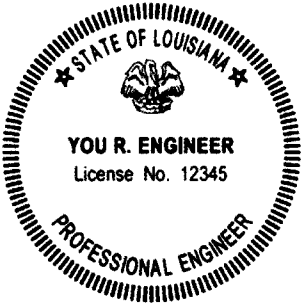

A.3. – A.5.b. ...

Mr. Landry presented the proposed revisions to Rule 2907 related to the standards of practice for boundary surveys. After discussion, the Board unanimously approved the motion made by Mr. Chustz, seconded by Dr. Gopu, to amend Rule 2907 as follows:

§2907. Property Boundary Survey

A. – F. ...

G. Plats and Maps. Every original plat or map of a property boundary survey should be a reproducible drawing at a suitable scale which clearly shows the results of the field work, computations, research and record information as

compiled and checked. The plat or map shall be prepared in conformity with the following guidelines.

G.1. – G.5. ...

6. A statement indicating the origin of azimuths or bearings shall be shown on each plat or map. If bearings are used, the basis of the bearing shall include one or more of the following:

G.6.a. ...

b. reference to the Louisiana state plane coordinate system with the appropriate zone and a controlling station(s) with coordinates and datum noted;

G.6.c. – H.11....

Mr. Landry discussed the proposed revisions to Rule 705 (relating to Board meetings), which were previously approved at the January 16, 2024 Board meeting, and Rule 2911 (relating to references to the Department of Natural Resources), which were previously approved at the February 27, 2024 Board meeting. After discussion, the Board unanimously approved the motion made by Ms. Bergeron, seconded by Ms. Williams, to proceed with the promulgation process for these proposed revisions.

The Board recessed at 10:15 a.m. and resumed at 10:30 a.m.

The Board reviewed Rule 3119 and the \$200 administrative fee charged to licensees who are deemed not in compliance with the Board’s CPD requirements. After discussion, the Board unanimously approved the motion made by Ms. Williams, seconded by Ms. Richard, for the Enforcement Committee to add language to the Disciplinary and Enforcement Sanction Guidelines which addresses repeat offenders of the Board’s CPD requirements.

The Board unanimously approved the motion made by Ms. Betts, seconded by Dr. Gopu, to remove from Rule 3119 the \$200 administrative fee charged to licensees who are deemed not in compliance with the Board’s CPD requirements.

After discussion, the Board approved the motion made by Dr. Gopu, seconded by Ms. Williams, with Ms. Betts, Mr. Racca, Mr. Chustz, Ms. Williams, Dr. Gopu, Mr. Nelson and Ms. Richard for and Ms. Bergeron against, to amend Rule 1703 as follows effective July 1, 2025 (with this version of the amendment to replace the version last approved at the February 27, 2024 Board meeting):

§1703. Fees

A. ...

B. Application fees, renewal fees and other fees shall be as follows:

Application Fees	
Licensure as a Professional Engineer by Examination	\$50
Licensure as a Professional Engineer by Comity	\$200
Licensure as a Professional Engineer by Endorsement	\$50
Licensure as a Professional Land Surveyor by Examination	\$50
Licensure as a Professional Land Surveyor by Comity	\$200
Licensure as a Professional Land Surveyor by Endorsement	\$50
Louisiana Laws of Land Surveying Examination	\$100
Temporary Engineering Permit (Individual)	\$200
Temporary Land Surveying Permit (Individual)	\$200
Certification as an Engineer Intern	\$20
Certification as a Land Surveyor Intern	\$20
Licensure as a Professional Engineering Firm	\$185
Licensure as a Professional Land Surveying Firm	\$185
Temporary Engineering Permit (Firm)	\$185

Renewal Fees	
Renewal of Licensure as a Professional Engineer in Active Status	\$140
Renewal of Licensure as a Professional Engineer in Active Status <i>(not in compliance with CPD requirements)</i>	\$200
Renewal of Licensure as a Professional Engineer in Retired Status	\$70
Renewal of Licensure as a Professional Engineer in Inactive Status	\$140
Renewal of Licensure as a Professional Land Surveyor in Active Status	\$140
Renewal of Licensure as a Professional Land Surveyor in Active Status <i>(not in compliance with CPD requirements)</i>	\$200
Renewal of Licensure as a Professional Land Surveyor in Retired Status	\$70
Renewal of Licensure as a Professional Land Surveyor in Inactive Status	\$140
Renewal of Certification as an Engineer Intern	\$60
Renewal of Certification as a Land Surveyor Intern	\$60
Renewal of Licensure as a Professional Engineering Firm	\$140
Renewal of Licensure as a Professional Land Surveying Firm	\$140
Late Renewal Fees	
Late Renewal of Licensure as a Professional Engineer in Active Status <i>(within 120 days after expiration)</i>	\$210
Late Renewal of Licensure as a Professional Engineer in Active Status <i>(within 120 days after expiration) (not in compliance with CPD requirements)</i>	\$350
Late Renewal of Licensure as a Professional Engineer in Retired Status <i>(within 120 days after expiration)</i>	\$105
Late Renewal of Licensure as a Professional Engineer in Inactive Status <i>(within 120 days after expiration)</i>	\$210
Late Renewal of Licensure as a Professional Land Surveyor in Active Status <i>(within 120 days after expiration)</i>	\$210
Late Renewal of Licensure as a Professional Land Surveyor in Active Status <i>(within 120 days after expiration) (not in compliance with CPD requirements)</i>	\$350
Late Renewal of Licensure as a Professional Land Surveyor in Retired Status <i>(within 120 days after expiration)</i>	\$105
Late Renewal of Licensure as a Professional Land Surveyor in Inactive Status <i>(within 120 days after expiration)</i>	\$210
Late Renewal of Licensure as a Professional Engineering Firm <i>(within 120 days after expiration)</i>	\$210
Late Renewal of Licensure as a Professional Land Surveying Firm <i>(within 120 days after expiration)</i>	\$210
Reactivation Fees	
Reactivation of Expired Professional Engineer License <i>(more than 120 days after expiration)</i>	\$280
Reactivation of Expired Professional Engineer License <i>(more than 120 days after expiration) (not in compliance with CPD requirements)</i>	\$420
Reactivation of Expired Professional Land Surveyor License <i>(more than 120 days after expiration)</i>	\$280
Reactivation of Expired Professional Land Surveyor License <i>(more than 120 days after expiration) (not in compliance with CPD requirements)</i>	\$420
Reactivation of Expired Engineer Intern Certification <i>(more than 120 days after expiration)</i>	\$60

Reactivation of Expired Land Surveyor Intern Certification (<i>more than 120 days after expiration</i>)	\$60
Reactivation of Expired Professional Engineering Firm License (<i>more than 120 days after expiration</i>)	\$280
Reactivation of Expired Professional Land Surveying Firm License (<i>more than 120 days after expiration</i>)	\$280
Other Fees	
Public Records	\$0.25 per page plus notary and postage charges

Applications

The Board discussed several applications for licensure as a professional engineer/professional land surveyor by endorsement which have been received since Acts 253 and 568 of the 2024 Regular Session of the Louisiana Legislature (Welcome Home Act) went into effect on August 1, 2024.

Committee Reports (continued)

Finance Committee

Ms. Bergeron presented the financial report for FY 24-25. After discussion, the Board unanimously approved the motion made by Mr. Nelson, seconded by Mr. Chustz, to accept the year-to-date budget for FY 24-25 as presented.

The Board unanimously approved the motion made by Mr. Chustz, seconded by Mr. Nelson, to renew the certificate of deposit at Citizen’s Bank when it matures on September 28, 2024.

The Board reviewed the request from Glenn Gaudet to change his licensure status to “retired status-waiver granted”. After discussion, the Board unanimously approved the motion made by Mr. Nelson, seconded by Dr. Gopu, to deny Mr. Gaudet’s request, but to advise him that he is eligible to change his licensure status to “retired status”.

Building Committee

Ms. Bergeron presented the report from the Building Committee, which included the timeline for the move of the Board’s office to the United Plaza building, requests for funds for security and an air conditioner unit for the server room, as well as the updated budget for the move.

The Board approved the motion made by Ms. Betts, seconded by Mr. Racca, to approve \$8,842 for the security system for the Board’s new office space at the United Plaza building.

The Board approved the motion made by Mr. Nelson, seconded by Dr. Gopu, to approve (a) \$18,487 for the installation of an air conditioner-mini split in the server room for the Board’s new office space at the United Plaza building and (b) the updated budget for moving expenses of \$100,410.

The Board recessed for lunch at 12:20 p.m. and resumed at 12:55 p.m.

Old Business/New Business

The Board unanimously approved the motion made by Mr. Nelson, seconded by Ms. Williams, to schedule the next Board meeting for Monday, November 4, 2024.

1 The Board unanimously approved the motion made by Ms. Bergeron, seconded by Ms.
2 Richard, to approve Board members and staff to attend the JESC Conference in
3 Lafayette, LA on February 5-6, 2025.
4

5 The Board unanimously approved the motion made by Ms. Betts, seconded by Ms.
6 Bergeron, to request NCEES emeritus status for Edgar Benoit, P.E.
7

8 At 1:03 p.m., the Board unanimously approved the motion made by Ms. Betts,
9 seconded by Ms. Bergeron, to enter into executive session to discuss personnel
10 matters.
11

12 At 1:27 p.m., the Board unanimously approved the motion made by Ms. Williams,
13 seconded by Mr. Nelson, to exit the executive session.
14

15 At 1:38 p.m., Mr. Racca and Dr. Gopu exited the meeting.
16

17 **Closing Business**
18

19 The Board unanimously approved the motion made by Ms. Betts, seconded by Ms.
20 Williams, to approve all committee recommendations and actions.
21

22 The Board unanimously approved the motion made by Ms. Bergeron, seconded by Ms.
23 Betts, to acknowledge and confirm all licenses and certificates issued and renewed
24 since the last Board meeting.
25

26 The Board unanimously approved the motion made by Ms. Betts, seconded by Mr.
27 Chustz, to approve all Board expenses.
28

29 The Board unanimously approved the motion made by Mr. Nelson, seconded by Mr.
30 Chustz, to adjourn.
31

32 The meeting adjourned at 1:43 p.m. on September 23, 2024.
33
34

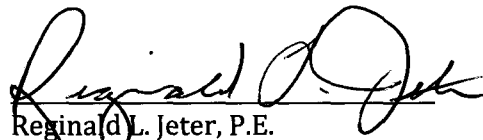
35
36
37 
38 Reginald L. Jeter, P.E.
39 Chairman
40

Byron D. Racca, P.E.
Secretary